

“Home is where our story begins...”

PARX RESIDENCY

NEAR CIFA, BHUBANESWAR



THE CITY AT A GLANCE

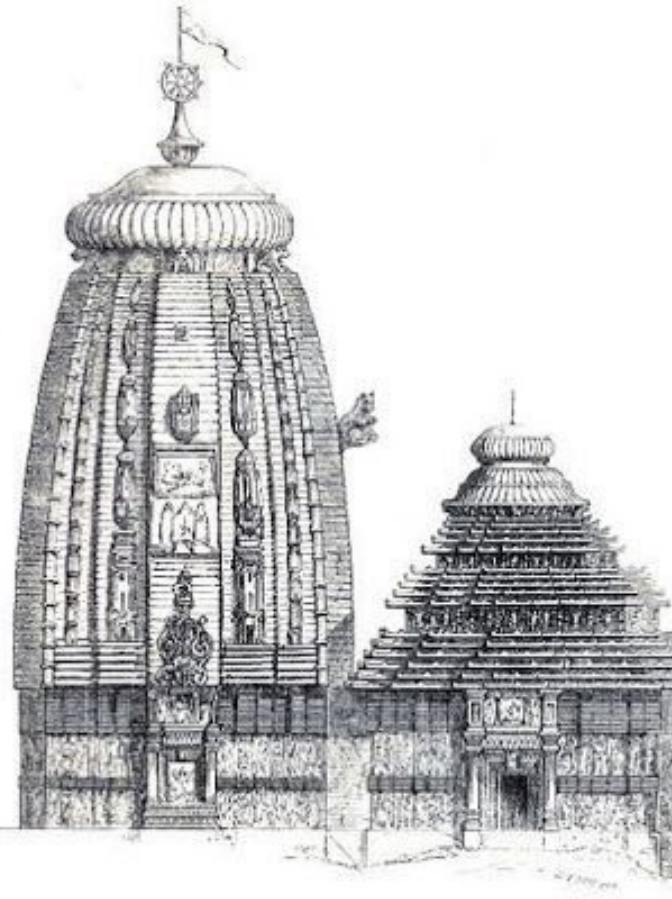

The capital city of Odisha - Bhubaneswar is the newest Indian city to have caught the fascination of India Inc's investment plans. One of the most compelling reasons for the growth of Real Estate In Bhubaneswar is without doubt because of the serene atmosphere and beautiful landscape. The Orissa government has welcomed the property investors with open arms, & is putting in best efforts to attract both national and foreign real estate investors. The government is further carrying out large scale infrastructural development in the state of Bhubaneswar to attract investments by realty hotshots. With more and more property investors showing interest in Property In Bhubaneswar, value property & land is skyrocketing. The IT sector in Bhubaneswar is among the fastest expanding fields. Reputed names & IT giants like TCS, Infosys and Wipro have a strong presence in the city. Residential Property In Bhubaneswar is also selling like hotcakes; residential projects are being lapped up by buyers who are not leaving behind any opportunity to be a part of real estate growth story in Bhubaneswar.



PARK RESIDENCY

PARK RESIDENCY

1000

1000

1000

1000

1000

1000

1000

1000

1000

1000

1000

1000



WHY US!

Inspired by the real
essence of life we have
conceptualized &
designed the PARX
RESIDEENCY.

A well designed living
space that fulfil your
housing needs and
your future
aspirations.



SPECIFICATIONS

Structure: M-25 RCC Frame Structure
Cement: Ultratech, ACC, JK Laxmi or Equivalent

Steel : TATA, Vizag, Jindal or Equivalent

Slab : 5" Thickness Slab

Bricks : Fly Ash Bricks

Flooring : 600mm x 600mm vitrified floor tiles in bedroom, dinning cum living , kitchen and Puja & Granite/marble finish to the staircase and corridor, Antiskid tiles on bathroom and balcony.

Kitchen : Granite platform with high grade SS Sink basin and 2' height ceramic tiles above the platform

Main Door: Tick wood with polish

Internal Door : Flush Door and PVC door on bathroom

Windows : UPVC double slide window with plane design MS grill

CP & Sanitary: Jaguar & Marks

Door Fitting : Godrej, Quba, Dorset

Electrical : Havells , Finolex, Legrands or Equivalent

PVC Pipe: Suprime, Astral, Ori-Plast, Hari-Plast

Wall Putty: Birla, JK or Asian

Painting : Asian , Dulux, Burger

Over Head Tank : Sintex

Balcony : SS railing

*TODAY AND WANTED TO THINK
ABOUT UNTIL TOMORROW MAY
BE THE SAME HOUSE SOMEONE
LOOKED AT YESTERDAY AND
WILL BUY TODAY*





3 BHK PLAN VIEW



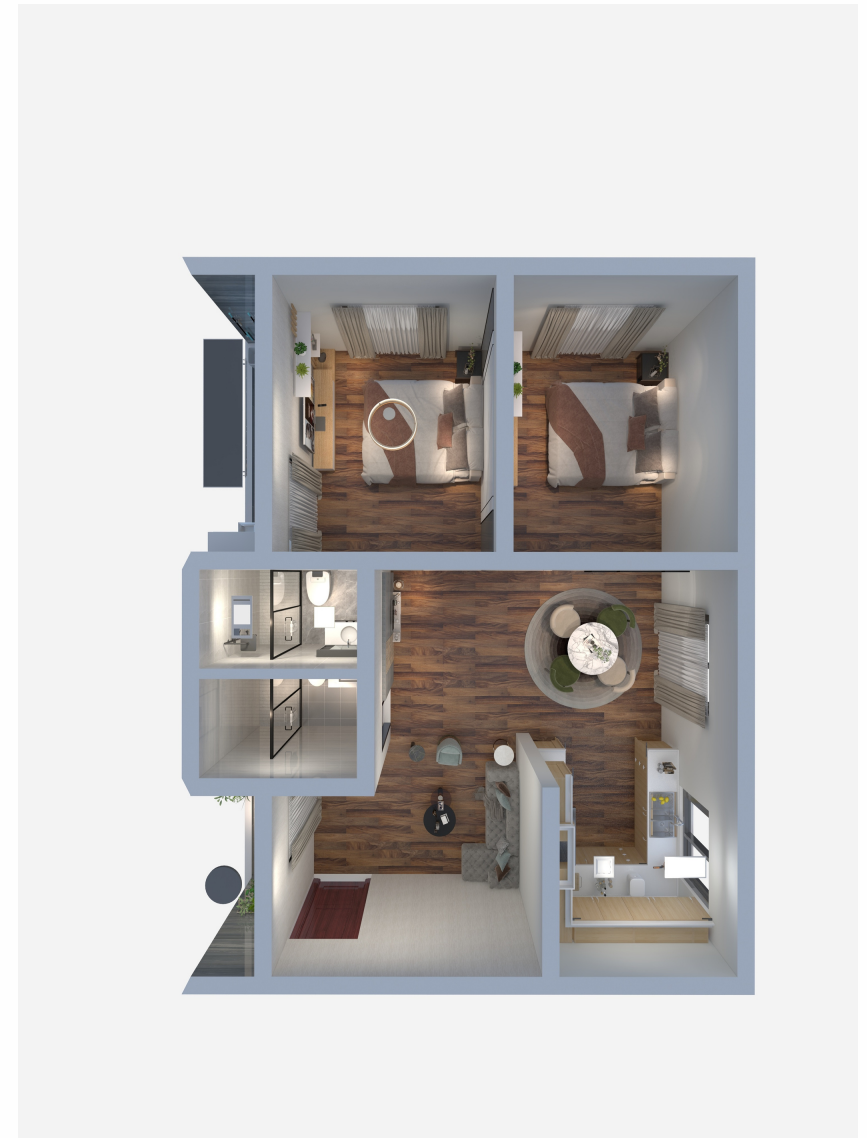

2 BHK PLAN VIEW

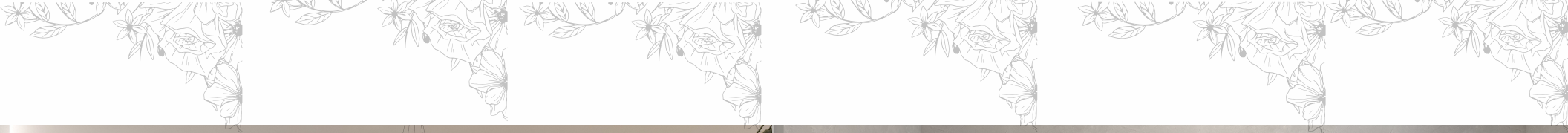



Location Map

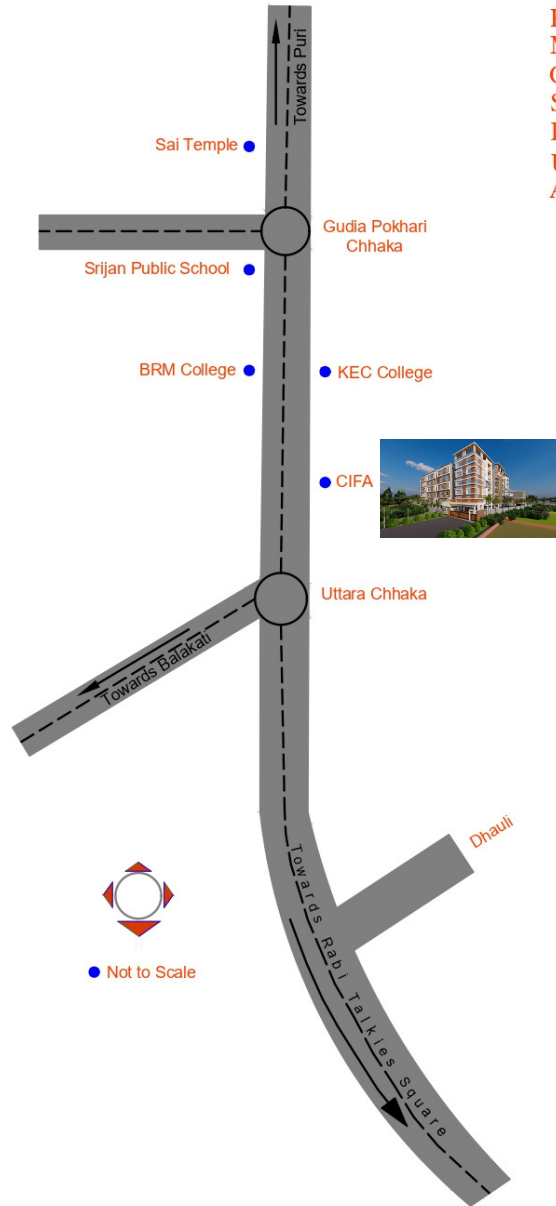

Distance From Project

KEC College : 0 K.M
Municipal Hospital : 4.5 K.M
CIFA : 00 K.M
Sai Temple : 1 K.M
Railway Station : 8 K.M
Uttara Chhaka : 0.5 K.M
Airport : 7.5 K.M

